

NEW PRODUCT

NEW



TT2



334A



New ELMY®
type00

TOMOE
TRITEC

THE TRIPLE OFFSET PROCESS VALVE

TT2

COST EFFECTIVE RELIABILITY

Fire safe certification to API607 4th Ed.



The TT2, triple offset process valve, has been added to the Tomoe Tritec series that has revolutionized the piping design of the process industry. The TT2 inherits the torque sealing-friction free sealing design while featuring new technology and improved performance. Tomoe now offers the ideal solution for increasing the efficiency of the plant and minimizing the cost of ownership.

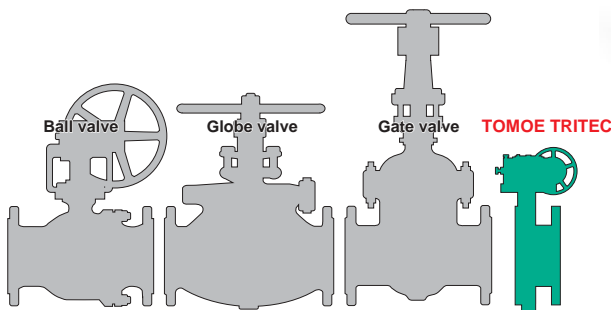
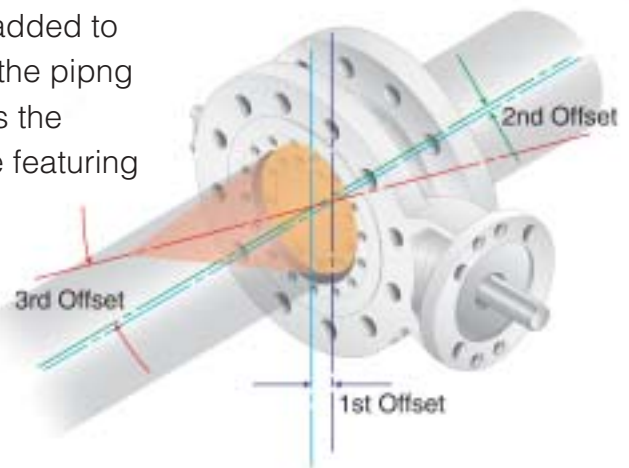

Light weight and space saving

Bi-directional Zero-leakage with metal seat

Long life

Fully field replaceable seat and seal design

TT2 Standard specifications		
Design	API 609 Cat. B, ASME B16.34	
Nominal Diameter	3" to 24"	
Pressure rating	Class 150, Class 300	
Body style	Wafer, Lugged and Double flanged short & long	
Flange connection	ASME B16.5, JPI, JIS, BS and DIN	
Pressure rating	ASME B16.34 Class 150 & 300 Range, API 609 Class 150 & 300 Range	
Standard materials	Body	ASTM A216 WCB or ASTM A351 CF8M
	Disc	ASTM A216 WCB or ASTM A351 CF8M
	Disc seal	ASTM 564 type630 H1150 + 1150
	Stem	Stainless steel type 316 with Graphite laminate
	Body seat	Stainless steel type 316

TT2 Pressure rating

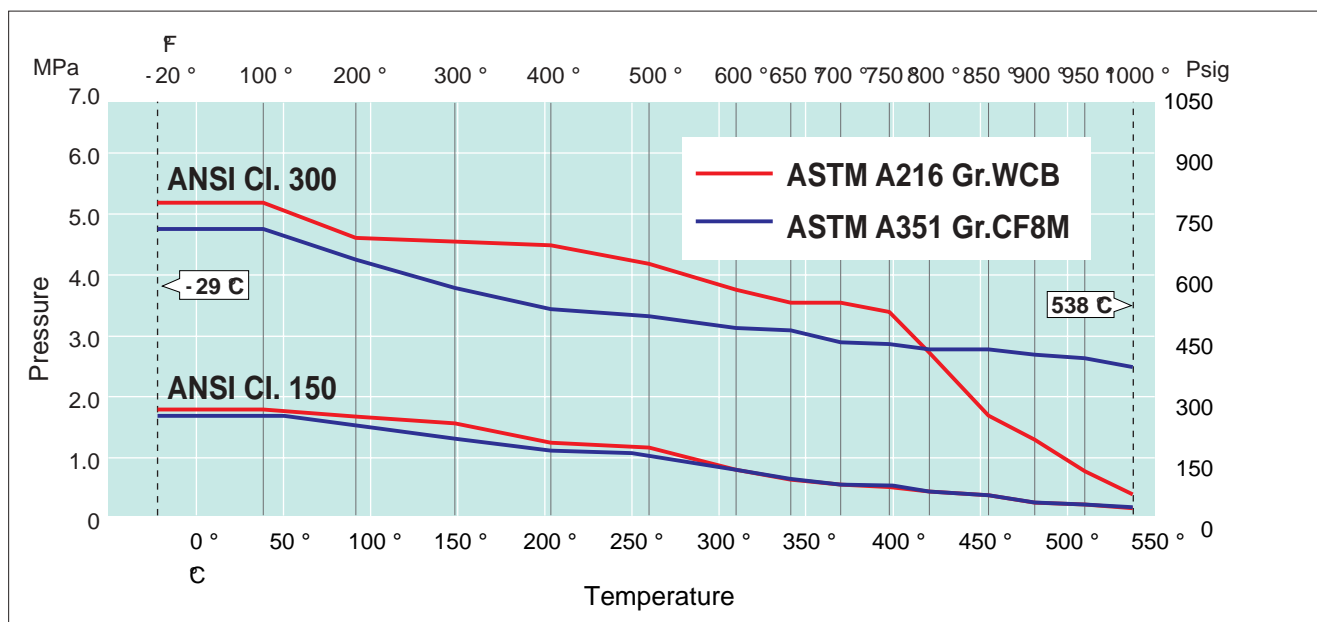

Wafer type

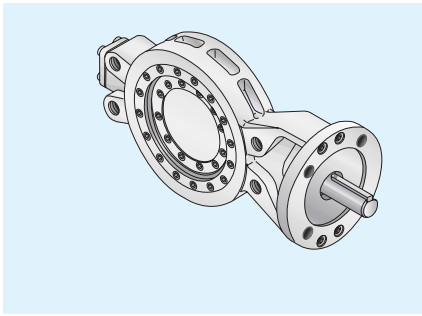

Lugged type

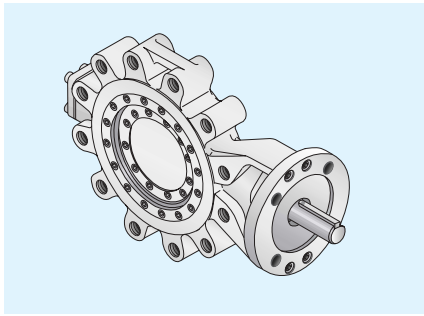

Flanged shat type

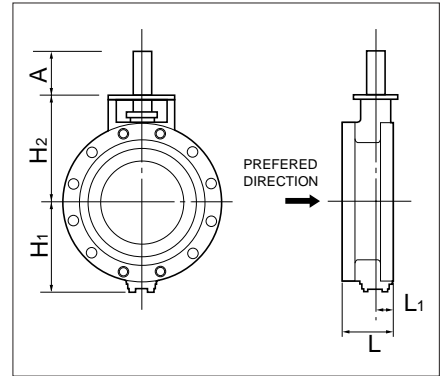
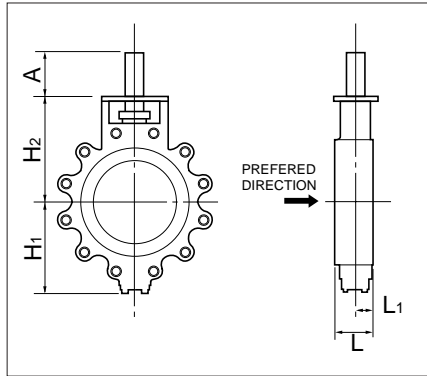
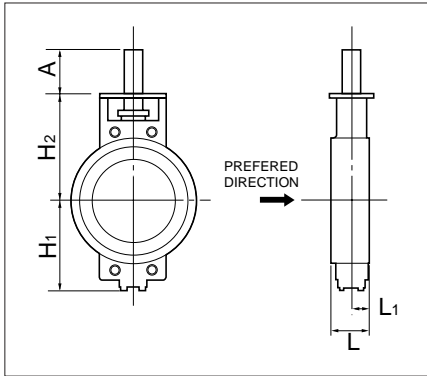
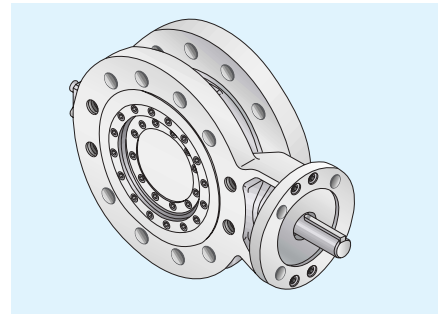

TT2 Dimensions (mm)

150Lb

Valve size		H ₁	H ₂	A	L ₁	L			Approx. weight(kg)		
mm	inch					Wafer type	Lugged type	Flanged shat type	Wafer type	Lugged type	Flanged shat type
80	3	127	159	34	29	48	48	114	8	7	16
100	4	151	194	34	31	54	54	127	12	14	23
150	6	177	242	34	37	57	57	140	20	22	37
200	8	195	237	34	41	64	64	152	29	31	54
250	10	227	277	64	46	71	71	165	47	54	80
300	12	266	325	79	53	81	81	178	70	80	120
350	14	293	352	79	61	92	92	190	88	96	160
400	16	336	425	79	64	102	102	216	111	139	199
450	18	356	443	79	75	114	114	222	168	194	249
500	20	391	482	79	81	127	127	229	197	237	328
600	24	463	550	109	97	154	154	267	322	413	454

300Lb

Valve size		H ₁	H ₂	A	L ₁	L			Approx. weight(kg)		
mm	inch					Wafer type	Lugged type	Flanged shat type	Wafer type	Lugged type	Flanged shat type
80	3	121	159	34	29	48	48	114	7	9	18
100	4	145	194	34	32	54	54	127	12	14	30
150	6	189	276	64	37	59	59	140	25	26	51
200	8	218	285	79	44	73	73	152	38	47	83
250	10	260	355	79	46	83	83	165	63	75	119
300	12	306	428	79	53	92	92	178	94	111	184
350	14	341	460	79	61	117	117	190	119	171	247
400	16	374	518	109	71	133	133	216	174	236	317
450	18	401	592	109	79	149	149	222	242	344	428
500	20	442	620	128	85	159	159	229	307	394	516
600	24	515	696	128	100	181	181	267	437	588	761

Class 300Lb Rating

334A

High Performance Butterfly Valve

Fire safe
certification to
API607 4th Ed.



NEW PRODUCT 334A

Double offset geometry

The axis of disc rotation is double offset to the seat ring. When the disc rotates, it unseats at a small turning angle by its cam effect. This prevents seat wear and provides reliable sealing performance over long periods.

Applications

General hydrocarbon, chemical process, steam, and gas applications.

334A RPTFE as standard

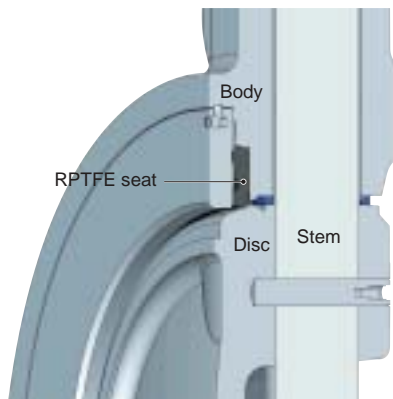

334A Fire safe seat (Option)

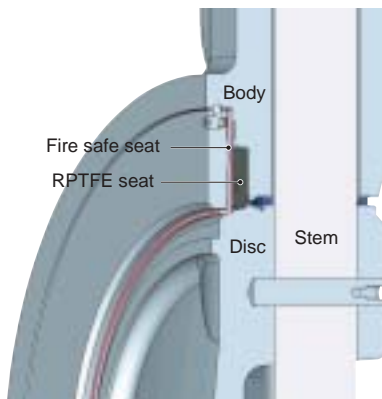

334A Standard specifications

Body Style	Wafer, Lugged, Double flanged	
Valve nominal size	80, 100, 150, 200, 250, 300, 350, 400, 450, 500, 600mm	
Applicable flange standard	ASME B16.5 Class300(API300), JPI300, JIS30K, BS4504 PN25/40, DIN NP25/40	
Face-to-face dimensions	API Category B, Class 300	
Seat leakage	ISO 5208 RATE A (Zero leakage), API598	
Flow direction	Bi-direction (Recommended flow direction : Pressrue to shaft side)	
Test pressure	Body Hydrostatic test	1.5 times of rating pressure
	Seat leakage	7 bar (Air) or 110% of rating pressure (Hydrostatic)
temperature range	- 29 to 232 degrees C	

334A Pressure rating

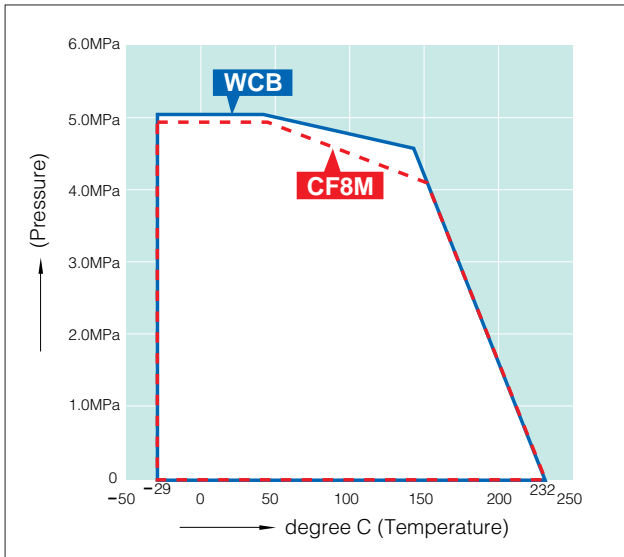

334A Expanded view of components

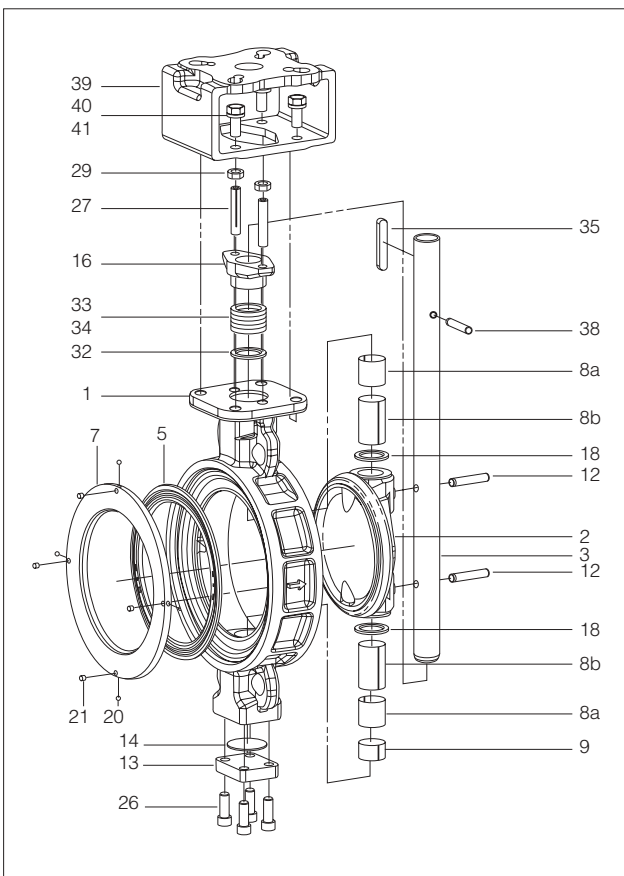

334A Parts list

No.	Description	Q'ty	Remarks
1	Body	1	
2	Disc	1	
3	Stem	1	
5	Seat ring	1	
7	Seat ring retainer	1	
8a	Bearing a	2	
8b	Bearing b	1	80mm to 150mm
		2	200mm to 600mm
9	Bearing spacer	1	
12	Taper pin	2	80mm to 200mm
		3	250mm to 600mm
13	Bottom cover	1	
14	Bottom gasket	1	
16	Gland plate spigot	1	
18	Spacer ring	2	
20	Ball	2	80mm, 100mm
		4	150mm to 600mm
21	Set screw	2	80mm, 100mm
		4	150mm to 600mm
26	Hexagon hole bolt	4	
27	Gland nut	2	
29	Hexagon nut	2	
32	Packing retainer	1	
33	Gland packing a	3	
34	Gland packing b	2	
35	Key	0	80mm to 150mm
		1	200mm to 600mm
38	Spring pin	1	
39	Column	1	
40	Hexagon bolt	4	
41	Spring washer	4	

The materials shown above are representative. All other materials and surface treatments are available on request, eg. Incoloy, Titanium, Monel, Hastelloy, Inconel, Stellite, Titanium Nitride.

334A Dimensions

Nominal size		Dimension (mm)													
mm	inch	d	D	L	L ₂	H ₁	H ₂	a ₁	a ₂	S ₁	d ₂	b	t ₂	H ₄	t
80	3	86.5	128	48	20	118	127	26.5	16.5	14	18	-	-	70	8
100	4	112	158	54	22	147	149	26.5	20	16	20	-	-	70	8
150	6	160	216	59	24	192	187	37	30	22	26	-	-	98	12
200	8	210	270	73	31	226	215	72	67	-	32	10	3	98	12
250	10	260	326	83	36	260	253	72	67	-	37	10	3	125	16
300	12	310	385	92	42	292	294.5	86	81	-	42	12	3	125	16
350	14	347	420	117	52	338	326	86	81	-	45	14	3.5	125	16
400	16	402	476	133	61.5	376	364	86	81	-	52	16	4	125	16
450	18	446	536	149	70	402	394.5	116	111	-	60	18	4	150	20
500	20	497	590	159	75	431	426.5	116	111	-	65	18	4	150	20
600	24	600	701	181	84	504	496	136	131	-	70	20	4.5	150	20

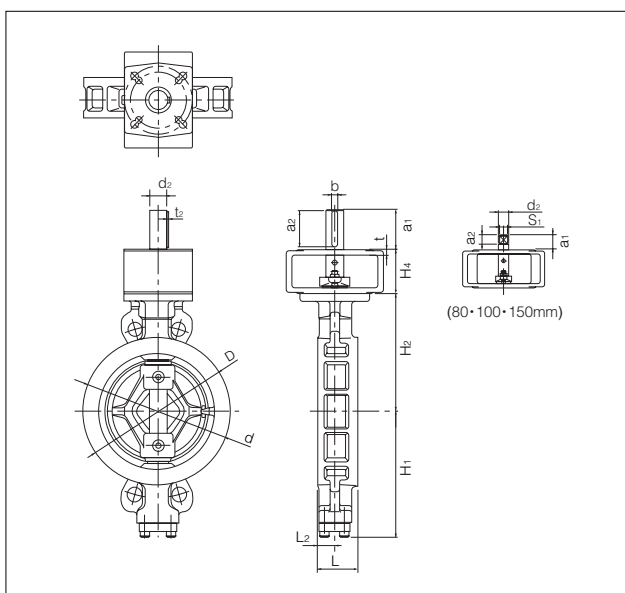

334A Minimum Internal Diameter of Piping

Nominal size		Minimum Internal Diameter of Piping (mm)
mm	inch	
80	3	71
100	4	93
150	6	138
200	8	185
250	10	225
300	12	270
350	14	309
400	16	350
450	18	397
500	20	440
600	24	526

334A Cv value

Nominal size		Valve opening																
mm	inch	10°	15°	20°	25°	30°	35°	40°	45°	50°	55°	60°	65°	70°	75°	80°	85°	90°
80	3	6	12	22	33	47	62	77	91	104	116	124	130	134	135	135	136	136
100	4	11	22	38	59	83	109	135	161	184	204	219	230	236	237	238	239	240
150	6	48	92	139	186	230	271	309	346	384	425	470	519	572	625	675	713	727
200	8	92	177	270	360	446	525	599	670	744	822	909	1004	1106	1210	1306	1380	1407
250	10	149	287	436	582	720	848	967	1083	1202	1329	1469	1622	1787	1955	2111	2230	2273
300	12	231	445	677	905	1120	1318	1503	1683	1868	2065	2283	2522	2778	3039	3281	3466	3533
350	14	310	598	909	1215	1503	1769	2018	2260	2508	2773	3065	3386	3730	4081	4405	4653	4744
400	16	426	822	1249	1670	2065	2431	2773	3105	3445	3810	4210	4652	5125	5606	6052	6393	6518
450	18	568	1095	1664	2225	2751	3238	3694	4137	4590	5075	5609	6197	6828	7469	8062	8517	8683
500	20	724	1396	2122	2838	3510	4131	4712	5277	5855	6474	7155	7905	8710	9528	10285	10865	11077
600	24	1108	2135	3245	4339	5366	6316	7205	8069	8953	9899	10941	12087	13317	14568	15725	16612	16937

New **ELMY**® *type00*

Type 00 - New Entry to TOMOE best selling motorized actuators.



Our New ELMY achieves a greater level of compactness while inheriting the excellent performance of our best selling ELMY dedicated motorized actuator for butterfly valves. Its performance is much superseded with improvements such as tough metal gears, a new limit cam mechanism, and an improved watertight design.



High output torque ever realized in its class.

New adjustable limit switch cam mechanism.

Enhanced waterproof design protects against rain water, etc.

Well designed compact housing to facilitate wiring.

Flip type cover for easy wiring.

New ELMY type00 Standard specifications

Type	Type 00
Output torque (N·m)	25
Power source (V)	AC 100, 200, 220
Motor capacity (W)	8
Travel time (50/60Hz) (sec.)	10/8
Rating (min.)	30
Insulation (class)	E
ISO flange	F05/07
Weight (kg)	2.1

New ELMY type00 Valve-Actuator selection table

Valve type	Nominal size (mm)
773Z	40 to 65
700G/705G/704G	40 to 50
731P	50
732P	50

New ELMY type00 Wiring diagram

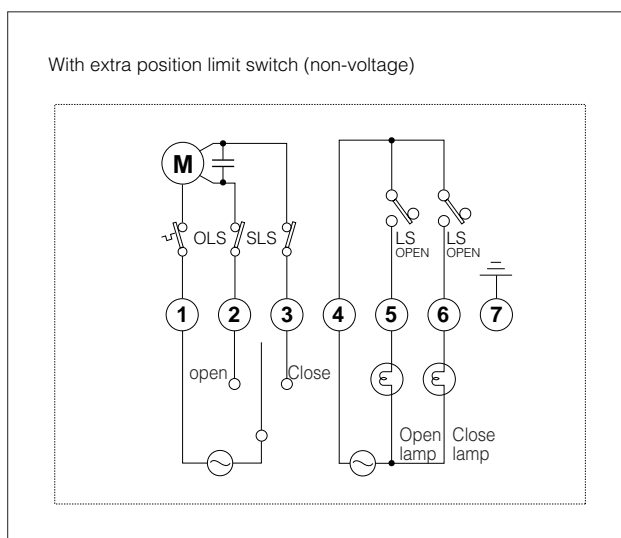

New ELMY type00 Dimensions

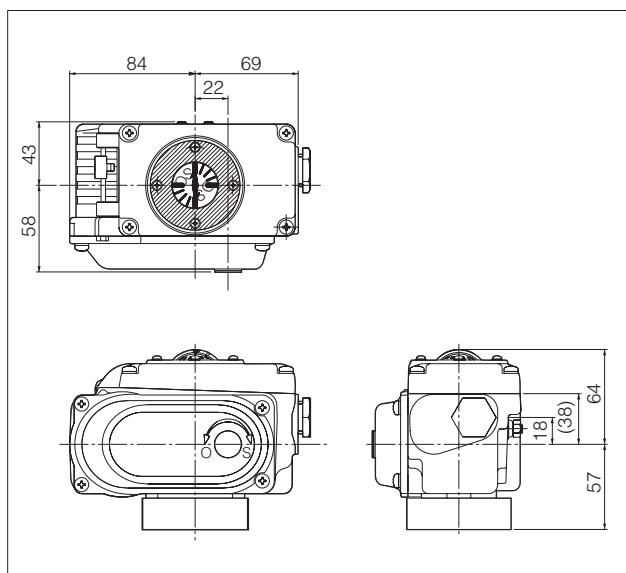

New ELMY type00 Mounting details

